

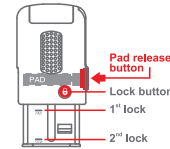

All-new self-inkers with push button pad removal system

PRINTER LINE



**Additional Charges**

|         |         |
|---------|---------|
| LOGO *  | \$6.00  |
| PROOF   | \$12.00 |
| ARTWORK | \$15.00 |



S-851

**COPY**

3/8" x 1"

S-852

**MR. & MRS. DAY**  
28 GLOW COURT  
GRIMSBY, NV 88901

9/16" x 1-1/2"

S-853

**S. J. Kreeger**  
1260 S.W. 54 Street  
Miami, Florida 33134  
Tel: (305) 274-1175

3/4" x 1-7/8"

S-854 \*

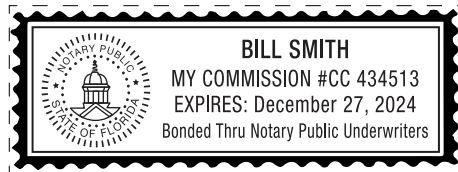

7/8" x 2-3/8"

S-855

**EASTMAIN FIRE & EMERGENCY**  
SALES AND SERVICE DEPT.  
3856 N.W. 75 STREET  
P.O. BOX 4567  
MIAMI, FLORIDA 33125  
TEL: (305) 365-4555 • FAX: (305) 365-4556

1" x 2-3/4"

S-846

PAY TO THE ORDER OF  
BANK ATLANTIC  
▶ 05325689 ◀  
FOR DEPOSIT ONLY  
INTERNATIONAL MORTGAGE CO.  
ESCROW ACCOUNT  
01080556790

1-1/16" x 2-9/16"

**S-851**

| Item No. | Description | List Price |
|----------|-------------|------------|
| S-851    |             | \$22.30    |
| S-851    | +           | \$25.00    |
| S-851    | +           | \$25.00    |

Ink Pad Series S-851-7

\$5.25

**S-852**

| Item No. | Description | List Price |
|----------|-------------|------------|
| S-852    |             | \$27.00    |
| S-852    | +           | \$29.70    |
| S-852    | +           | \$29.70    |

Ink Pad Series S-852-7

\$5.35

**S-853**

| Item No. | Description | List Price |
|----------|-------------|------------|
| S-853    |             | \$31.90    |
| S-853    | +           | \$34.60    |
| S-853    | +           | \$34.60    |

Ink Pad Series S-853-7

\$6.35

**S-854**

| Item No. | Description | List Price |
|----------|-------------|------------|
| S-854    |             | \$35.50    |
| S-854    | +           | \$38.20    |
| S-854    | +           | \$38.20    |

Ink Pad Series S-854-7

\$7.50

**S-855**

| Item No. | Description | List Price |
|----------|-------------|------------|
| S-855    |             | \$43.40    |
| S-855    | +           | \$46.10    |
| S-855    | +           | \$46.10    |

Ink Pad Series S-855-7

\$8.65

**S-846**

| Item No. | Description | List Price |
|----------|-------------|------------|
| S-846    |             | \$43.40    |
| S-846    | +           | \$46.10    |
| S-846    | +           | \$46.10    |

Ink Pad Series S-846-7

\$8.65



# PRINTER LINE

| Additional Charges |         |
|--------------------|---------|
| LOGO               | \$6.00  |
| PROOF              | \$12.00 |
| ARTWORK            | \$15.00 |



S-510

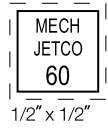

1/2" x 1/2"

S-520



3/4" x 3/4"

S-530

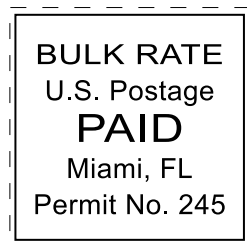

1-1/4" x 1-1/4"

S-827

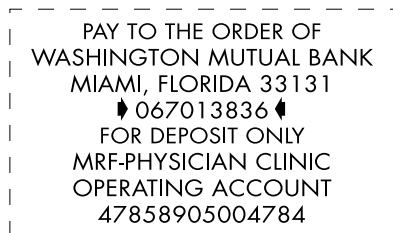

1-3/16" x 2"

S-837

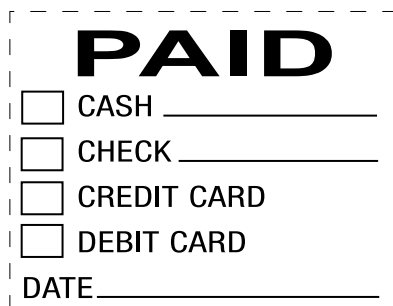

1-9/16" x 2"

## S-510

| Item No. | Description | List Price |
|----------|-------------|------------|
| S-510    |             | \$26.10    |
| S-510    | +           | \$28.80    |
| S-510    | +           | \$28.80    |

Ink Pad Series S-510-7 \$5.85

## S-520

| Item No. | Description | List Price |
|----------|-------------|------------|
| S-520    |             | \$29.40    |
| S-520    | +           | \$32.10    |
| S-520    | +           | \$32.10    |

Ink Pad Series S-520-7 \$6.50

## S-530

| Item No. | Description | List Price |
|----------|-------------|------------|
| S-530    |             | \$43.40    |
| S-530    | +           | \$46.10    |
| S-530    | +           | \$46.10    |

Ink Pad Series S-530-7 \$6.85

## S-827

| Item No. | Description | List Price |
|----------|-------------|------------|
| S-827    |             | \$44.70    |
| S-827    | +           | \$47.40    |
| S-827    | +           | \$47.40    |

Ink Pad Series S-827-7 \$7.90

## S-837

| Item No. | Description | List Price |
|----------|-------------|------------|
| S-837    |             | \$47.30    |
| S-837    | +           | \$50.00    |
| S-837    | +           | \$50.00    |

Ink Pad Series S-837-7 \$10.70



# PRINTER LINE



S-310



1/2" x 2-1/8"



S-831



3/8" x 2-3/4"



S-832



5/8" x 2-15/16"



S-833



1" x 3-1/4"



S-829\*



1-9/16" x 2-1/2"



S-857



1-1/2" x 3"

## Additional Charges

|         |         |
|---------|---------|
| LOGO *  | \$6.00  |
| PROOF   | \$12.00 |
| ARTWORK | \$15.00 |

## S-310

| Item No. | Description | List Price |
|----------|-------------|------------|
| S-310    |             | \$31.00    |
| S-310    | +           | \$33.70    |
| S-310    | +           | \$33.70    |

Ink Pad Series S-857-7 \$6.60

## S-831

| Item No. | Description | List Price |
|----------|-------------|------------|
| S-831    |             | \$33.10    |
| S-831    | +           | \$35.80    |
| S-831    | +           | \$35.80    |

Ink Pad Series S-831-7 \$7.70

## S-832

| Item No. | Description | List Price |
|----------|-------------|------------|
| S-832    |             | \$35.90    |
| S-832    | +           | \$38.60    |
| S-832    | +           | \$38.60    |

Ink Pad Series S-832-7 \$8.00

## S-833

| Item No. | Description | List Price |
|----------|-------------|------------|
| S-833    |             | \$43.90    |
| S-833    | +           | \$46.60    |
| S-833    | +           | \$46.60    |

Ink Pad Series S-833-7 \$8.25

## S-829

| Item No. | Description | List Price |
|----------|-------------|------------|
| S-829    |             | \$49.70    |
| S-829    | +           | \$52.40    |
| S-829    | +           | \$52.40    |

Ink Pad Series S-829-7 \$10.70

## S-857

| Item No. | Description | List Price |
|----------|-------------|------------|
| S-857    |             | \$49.70    |
| S-857    | +           | \$52.40    |
| S-857    | +           | \$52.40    |

Ink Pad Series S-857-7 \$10.70



## PRINTER LINE



R-517 \*\*  
1 1/16" Diameter



R-524 \*\*  
1" Diameter



R-532 \*\*  
1-1/4" Diameter



R-542 \*\*  
1-5/8" Diameter

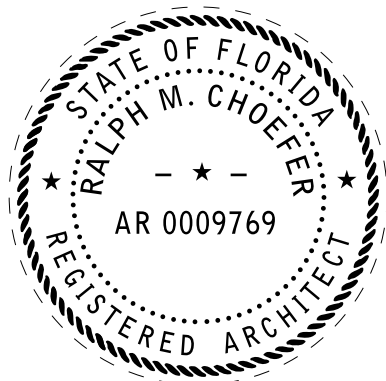

R-552 \*\*  
2" Diameter

### Additional Charges

|            |         |
|------------|---------|
| LOGO *     | \$6.00  |
| PROOF      | \$12.00 |
| ARTWORK ** | \$15.00 |

### R-517

| Item No. | Description | List Price |
|----------|-------------|------------|
| R-517    |             | \$29.60    |
| R-517    | +           | \$32.30    |
| R-517    | +           | \$32.30    |

Ink Pad Series R-517-7 \$6.50

### R-524

| Item No. | Description | List Price |
|----------|-------------|------------|
| R-524    |             | \$32.30    |
| R-524    | +           | \$35.00    |
| R-524    | +           | \$35.00    |

Ink Pad Series R-524-7 \$6.60

### R-532

| Item No. | Description | List Price |
|----------|-------------|------------|
| R-532    |             | \$43.40    |
| R-532    | +           | \$46.10    |
| R-532    | +           | \$46.10    |

Ink Pad Series R-532-7 \$6.85

### R-542

| Item No. | Description | List Price |
|----------|-------------|------------|
| R-542    |             | \$57.90    |
| R-542    | +           | \$60.60    |
| R-542    | +           | \$60.60    |

Ink Pad Series R-542-7 \$10.45

### R-552

| Item No. | Description | List Price |
|----------|-------------|------------|
| R-552    |             | \$68.20    |
| R-552    | +           | \$70.90    |
| R-552    | +           | \$70.90    |

Ink Pad Series R-552-7 \$12.75

50% METAL, 50% PLASTIC, 100% VALUE

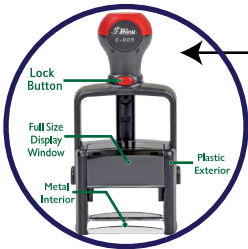

# HEAVY DUTY PLAINS

## Additional Charges

|         |         |
|---------|---------|
| LOGO *  | \$6.00  |
| PROOF   | \$12.00 |
| ARTWORK | \$15.00 |

## E-900

| Item No. | Description | List Price |
|----------|-------------|------------|
| E-900    |             | \$50.40    |
| E-900    | +           | \$53.10    |
| E-900    | +           | \$53.10    |

Ink Pad Series 900-7 \$7.50

E-900

PRESORTED  
STANDARD  
U.S. POSTAGE PAID  
W. PALM BEACH, FL  
PERMIT NO. 1899

15/16" x 1-5/8"

## E-903

| Item No. | Description | List Price |
|----------|-------------|------------|
| E-903    |             | \$55.60    |
| E-903    | +           | \$58.30    |
| E-903    | +           | \$58.30    |

Ink Pad Series 903-7 \$8.00

E-903

**PAID**

CASH     CREDIT CARD  
 CHECK     DEBIT CARD

DATE \_\_\_\_\_

1-3/16" x 2"

## E-904

| Item No. | Description | List Price |
|----------|-------------|------------|
| E-904    |             | \$58.90    |
| E-904    | +           | \$61.60    |
| E-904    | +           | \$61.60    |

Ink Pad Series 906-7 \$11.50

E-904 \*

**FLOXIN<sup>®</sup>**  
(ofloxacin otic solution) 0.3% **OTIC DROPS**

*b.i.d.*

5 ml     10 ml

1" x 2-3/16"

## E-906

| Item No. | Description | List Price |
|----------|-------------|------------|
| E-906    |             | \$64.85    |
| E-906    | +           | \$67.55    |
| E-906    | +           | \$67.55    |

Ink Pad Series 906-7 \$11.50

E-906

**SUNSHINE CHECK LIST**

| DEPARTMENT     | DATE | INIT. |
|----------------|------|-------|
| Site Manager   |      |       |
| Production     |      |       |
| Site Engineer  |      |       |
| Asst. Engineer |      |       |

1-5/16" x 2-3/16"

## E-907

| Item No. | Description | List Price |
|----------|-------------|------------|
| E-907    |             | \$70.50    |
| E-907    | +           | \$73.20    |
| E-907    | +           | \$73.20    |

Ink Pad Series 907-7 \$11.60

E-907

**Delta Construction, Corp.**  
**ACCT. DEPARTMENT**

DATE # \_\_\_\_\_  
PROJECT # \_\_\_\_\_  
LOAN # \_\_\_\_\_  
AGENT # \_\_\_\_\_  
INITIALS \_\_\_\_\_

1-9/16" x 2-3/8"



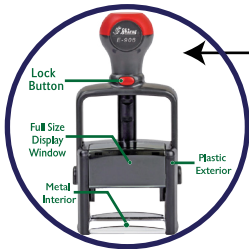

50% METAL, 50% PLASTIC, 100% VALUE

# HEAVY DUTY PLAINS

## Additional Charges

|         |         |
|---------|---------|
| LOGO    | \$6.00  |
| PROOF   | \$12.00 |
| ARTWORK | \$15.00 |



E-908

### Sun-Air Construction, Inc.

|            |           |      |
|------------|-----------|------|
| Job No.    |           |      |
| Approvals  | Signature | Date |
| Art. Dept. |           |      |
| Copy       |           |      |
| Account    |           |      |
| Svc.       |           |      |
| Proffer    |           |      |
| Client     |           |      |

1-7/8" x 2-5/8"

## E-908

| Item No. | Description | List Price |
|----------|-------------|------------|
| E-908    |             | \$78.85    |
| E-908    | +           | \$81.55    |
| E-908    | +           | \$81.55    |

Ink Pad Series 908-7 \$13.35



HM-6014

## ALL DIMENSIONS ARE CERTIFIED AS ON ORIGINAL DRAFT

REVISIONS MADE ARE RECORDED AND FILED BY THE FOLLOWING:

INITIAL & DATE

2-3/8" x 3-1/2" - Heavy Metal

## HM-6014

| Item No. | Description | List Price |
|----------|-------------|------------|
| HM-6014  |             | \$165.00   |
| HM-6014  | +           | \$167.70   |
| HM-6014  | +           | \$167.70   |

Ink Pad Series 6014-7 \$16.35



HM-6015

## QC - PEER - QA REVIEW

| PHASE  | SIGNATURE | DATE |
|--|-----------|------|
| ORIGINATOR<br>(Ready for Checking)                         |           |      |
| CHECKED Correct (Yellow) OK<br>Change (Red)                |           |      |
| BACKCHECKED (OK - Green<br>Check or Stet - Green Cross)    |           |      |
| CHANGE INCORPORATION<br>(Blue Circle) Change               |           |      |
| VERIFICATION CHECKER<br>(Green Highlighter or Green Check) |           |      |

2-1/2" x 4-1/2" - Heavy Metal

## HM-6015

| Item No. | Description | List Price |
|----------|-------------|------------|
| HM-6015  |             | \$181.70   |
| HM-6015  | +           | \$184.40   |
| HM-6015  | +           | \$184.40   |

Ink Pad Series 6015-7 \$18.50